

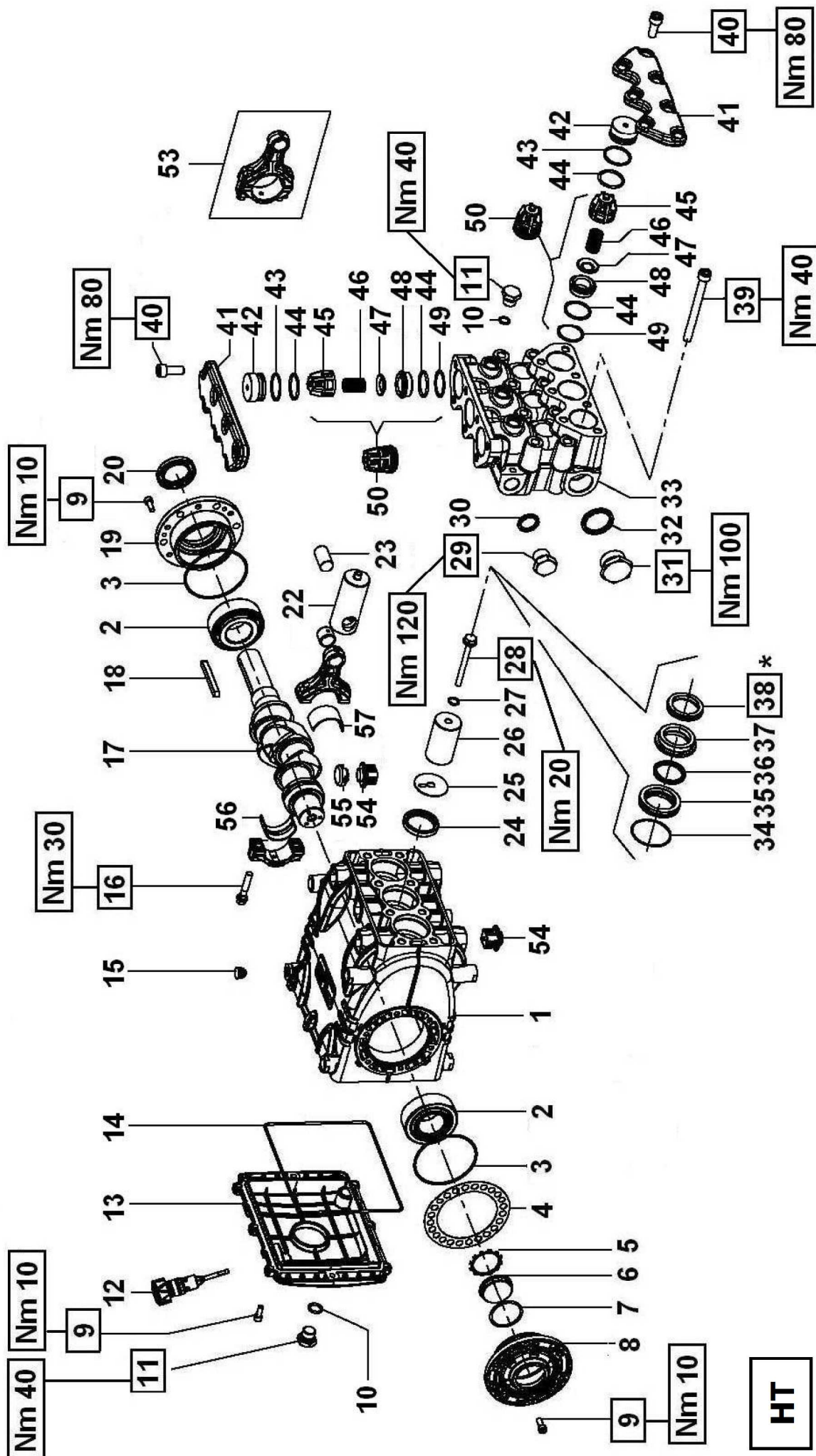

- * Lubrificare con grasso al silicone.
- * Lubricate with silicon grease.
- * Graisser avec de la graisse su silicone.
- * Schmieren mit Silikonfett.
- * Lubrique con grasa de silicona.
- * Lubrifique com graxa de silicone.



HT

SERIE 70



HT7095H

KIT RICAMBI – SPARE KITS

KIT NR.	KIT 212	KIT 2030	KIT 2032	KIT 2156 2157-2158
Posizioni include Positions included	36 - 38	44 - 45 46 - 47 48 - 49 (50)	34 - 35 36 - 37 38	56 - 57
Nr. Pcs.	3	6	1	3

POS	COD.	DESCRIZIONE – DESCRIPTION - KIT	NR
1	70.0100.22	Carter pompa	1
2	91.8477.00	Cuscinetto a rulli 33207	2
3	90.3915.00	OR Ø 80.6x2.62 (3318)	2
4	70.2200.81 70.2203.81	Spessore 0.1 mm. Spessore 0.25 mm.	- -
5	90.0756.00	Anello seeger Ø 45	1
6	70.2118.01	Spia livello olio	1
7	90.3877.00	OR Ø 39.34x2.62 (3156)	1
8	70.1501.22	Coperchio cuscinetto lato spia	1
9	99.1854.00	Vite M6x16 UNI 5931	20
10	90.3833.00	OR Ø 13.95x2.62 (3056)	4
11	98.2099.00	Tappo G 3/8"x13	4
12	98.2115.00	Tappo con asta Ø 21.5x70	1
13	70.1600.22	Coperchio posteriore carter	1
14	90.3944.00	OR Ø 196.52x2.62 (3775)	1
15	98.2005.00	Tappo per foro Ø 15	7
16	99.3123.00	Vite serraggio biella	6
17	70.0200.35	Albero ecc.	1
18	91.4900.00	Linguetta 8x7x70 UNI 6604	1
19	70.1500.22	Coperchio ciscinetto lato PTO	1
20	90.1668.00	Anello rad. Ø 35x52x7	1
22	70.0500.15	Guida pistone	3

POS	COD.	DESCRIZIONE – DESCRIPTION – KIT	NR
23	97.7420.00	Spinotto Ø 18x36	3
24	90.1677.00	Anello rad. Ø 36x47x6/7.5	3
25	96.7099.00	Rosetta Ø 10x45x1	3
26	70.0405.09	Pistone Ø 36x62	3
27	90.3671.00	OR Ø 11x2	3
28	70.2195.66	Vite fissaggio pistone	3
29	98.2182.00	Tappo G 1/2"x18	1
30	93.1972.00	Rondella con tenuta G 1/2"	1
31	98.2326.00	Tappo G 1"x17	1
32	93.1985.00	Rondella con tenuta G 1"	1
33	70.1241.41 70.1242.41	Testata Ø 36 Testata Ø 36 - NPT	1 1
34	90.3626.00	OR Ø 50.52x1.78 (2200)	2132 3
35	70.0805.70	Anello di fondo Ø 36	2132 3
36	90.2400.00	Anello ten. alt. Ø 36x42 LP	212-2132 3
37	70.2165.70	Anello intermedio Ø 36	2132 3
38	90.2410.00	Anello ten. alt. Ø 36x48x8 HP	212-2132 3
39	99.3816.00	Vite M10x110 UNI 5931	8
40	99.3671.00	Vite M10x25 UNI 5931	14
41	70.2223.41	Coperchio valvole	2
42	70.2116.70	Tappo valvole aspirazione/mandata	6
43	90.5180.00	Anello antiest. Ø 32.4x36.5x1.5	6

POS	COD.	DESCRIZIONE – DESCRIPTION – KIT	NR
44	90.3865.00	OR Ø 29.82x2.62 (3118)	2030 12
45	36.2047.05	Guida valvola	2030 6
46	94.7450.00	Molla Ø 16x27.5	2030 6
47	36.2010.76	Valvola sferica	2030 6
48	36.2048.66	Sede valvola	2030 6
49	90.5178.00	Anello antiest. Ø 31x35.5x1.5	2030 6
50	36.7143.01	Gruppo valvola aspiraz./mand.	2030 6
53	70.0305.01	Biella – Completa	3
54	70.2225.51	Tappo carter	6
55	71.2259.51	Cappuccio tappo carter	3
56	90.9223.00 90.9224.00 90.9225.00	Semiboc. testa biella – Inf. Semiboc. testa biella +0.25 – Inf. Semiboc. testa biella +0.50 – Inf.	2156 2157 2158 3 3 3
57	90.9220.00 90.9221.00 90.9222.00	Semiboc. testa biella – Sup. Semiboc. testa biella +0.25 – Sup. Semiboc. testa biella +0.50 – Sup.	2156 2157 2158 3 3 3

DIS. COD. 36.9535.00

BH210

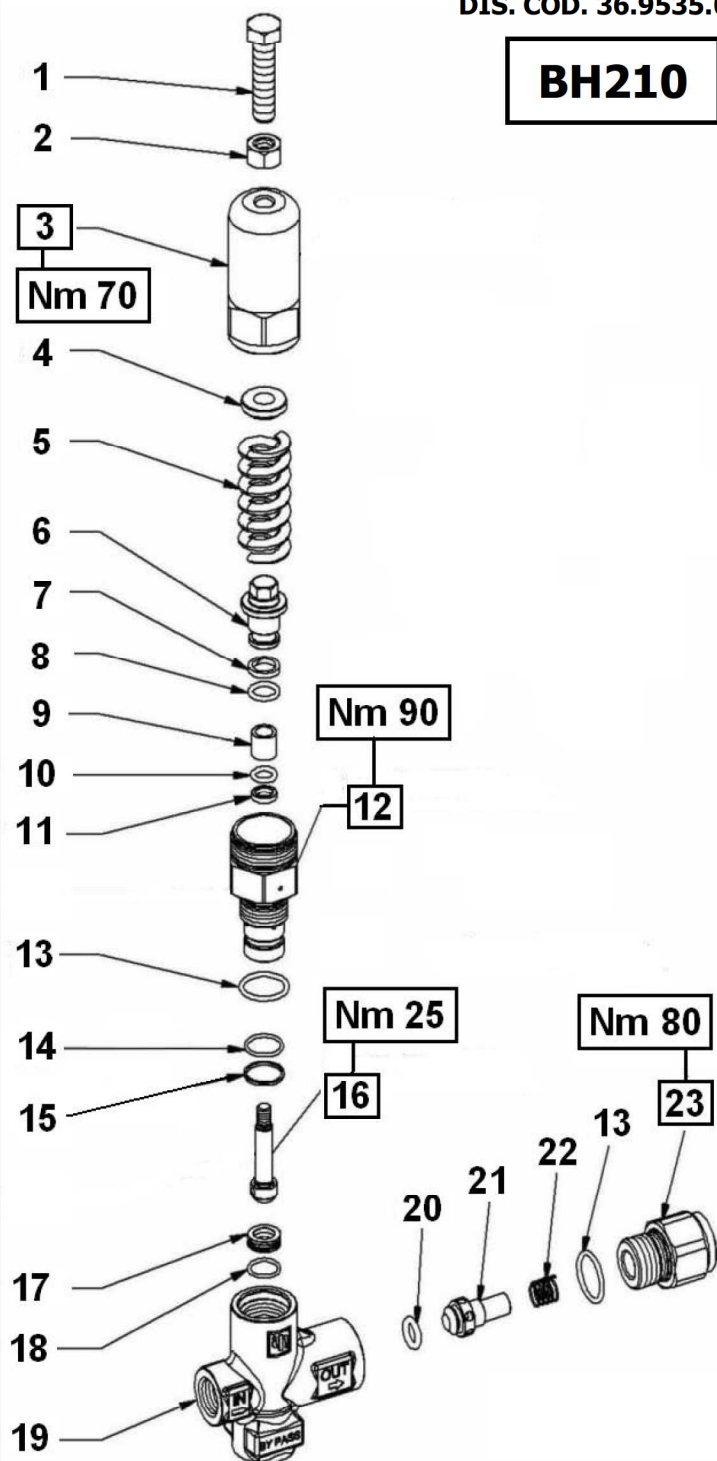

POS	COD.	DESCRIZIONE – DESCRIPTION KIT	NR
1	99.3732.00	Vite M12x50 UNI 5739	1
2	92.2395.00	Dado M12x19x10 UNI 5588	1
3	36.3375.71	Corpo superiore	1
4	36.3376.64	Piattello molla	1
5	94.7535.00	Molla Ø 24x66	1
6	36.3378.66	Pistone 246	1
7	90.5079.00	Anello antiest. Ø 13.6x18x2.5/3 246	1
8	90.3830.00	OR Ø 13.1x2.62 (117) 246	1
9	36.3384.82	Distanziale Ø 10x14.5x13.5 246	1
10	90.3823.00	OR Ø 9.92x2.62 (112) 246	1
11	90.5060.00	Anello antiest. Ø 10x14.7x2.5/3 246	1
12	36.3377.70	Boccola di guida	1
13	90.3855.00	OR Ø 23.47x2.62 (3093) 246	2
14	90.3596.00	OR Ø 18.77x1.78 (2075) 246	1
15	90.5131.00	Anello antiest. Ø 20.4x23x1.5 246	1
16	36.3380.56	Asta valvola 246	1
17	36.3381.66	Sede Ø 12 246	1
18	90.3593.00	OR Ø 15.6x1.78 (2062) 246	1
19	36.3379.41	Corpo valvola	1
20	90.4031.00	OR Ø 10.69x3.53 (4042) 246	1
21	36.3382.70	Otturatore	1
22	94.7409.00	Molla Ø 12.7x15	1
23	36.3383.70	Nipplo otturatore G 1/2"	1

KIT RICAMBI – SPARE KITS

KIT NR.	KIT 246
Posizioni includere Positions included	6 – 7 – 8 – 9 10 – 11 – 13 – 14 15 – 16 – 17 – 18 20
Nr. Pcs.	1